

**CT-16**

**AUDIO RECORDER JAMMER**

***USER MANUAL***



**PACKING LIST**

- Audio Recorder Jammer Host 1pcs
- Power Adaptor 1pcs
- Remote Control 1pcs

## APPEARANCE

The Jammer Host and related accessories as shown below: :



Figure1—Host Front View



Figure2—Host Back View



Figure3—Powr Adaptor

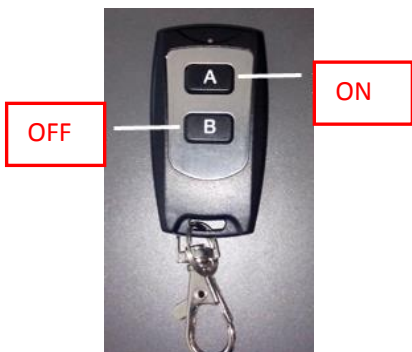

Figure 4—Remote Control

## INTRODUCTIONS

The audio recording device uses the high secured encryption algorithm for encryption operation and use high and low frequency sound source mixing to deal with the random number of encryption, to create the silent and mixed interference signal which can not be restored, to block the audio recording devices.

# **START TO USE**

## **Power Supply:**

This product uses the power adapter to work and recharge, adapter interface shown in Figure 2. As shown in Figure 3, The power adapter indicator light on while connected with the Jammer host; when not powered light off. The Jammer can also work by built-in battery after fully charged, the working time of battery up to 2 hours. When the Jammer fully charged, the Indicator light of the power adaptor will become green color, the indicator light is red while charging or working.

## **Turn on/off the Jamming function:**

This product has two states: the working state and the standby state. The default is the standby state after connected the power supply. When you turn on the recording jamming function, enter the work state, When turning off the recording truncation into standby mode.,

You can turn on or off the recording jamming function on the remote control or via the ON/OFF Button on the rear panel of the host:

Remote control shown in Figure 4, which "A" key represents "ON" , "B" key represents "OFF" . Press the "A" key to turn on the recording jamming function; press "B" key to turn off the recording recording jamming function.

Push The ON/OFF Button on the rear panel of the Jammer host to the "ON" position to turn on the recording jamming function; push the Button to the position "OFF" to turn off the recording jamming.

## **Adjust the angle of jamming:**

As shown in Figure 1, the jamming transmitter is in front of the panel. In order to achieve optimal jamming effect, please adjust the position and angle according to the actual situation

For general recording equipment, jamming distance from the present product is about 1.5 meters, and the jamming angle about 90 degrees. Different recording equipment, its distance and angle may vary. Some models jamming distance is more than two meters, the angle greater than 120 degrees, but a few models which may be less than 1 meter distance, the angle less than 60 degrees. When in use, please try to make the distance of the transmitter and recording device is within 1.5 m of the angle (mainly MIC port) less than 45 degrees, the closer and the smaller the angle, the better jamming effect.

When using, please be careful not to have barrier (such as clothing, body, etc.) in front of the Jammer transmitter, otherwise it will affect the jamming function.

### **Adjust the output power of jamming:**

This output power of the Jammer transmitter can be adjusted. The Jammer supports three levels of power: 1/2/3 levels of power. The higher power series, the greater the distance and jamming angle.

AS Shown in Figure 1, the user can press the power adjusting white button on the front panel of to adjust the power. When you open the recording truncation, the default is a minimum power level 1. After pressed the button moved to level 2, after pressed again to the level 3. After the third time pressing, go back to a power level 1. This cycle repeated.

### **Specifications:**

Jamming target: mobile phone, voice recorder, tape recorders and other recording equipment ;

Jamming distance: 0.5 to 8 meters depending on the jamming target ;

Jamming angle: 90 degrees (horizontal / vertical)

Remote control distance: more than 10 m

Size: 250\*195\*135mm

Net Weight: 5kg

### **Features:**

Shape can be customized. Product form can be customized according to user needs.

Easy to hide. It may be disguised as a variety of items, while retaining part of the original function.

Use remote control switch, easy to operate.

Output power adjustable.

### **Notes:**

Power Adapter: Use only factory supplied dedicated adapter.

Remote control: Do not use other remote controllers;

Temperature: When the product is working, there will be some increase in temperature, which is a normal phenomenon. But please do not continue to work more than 3 hours of time, in order to avoid overheating. If you want to work for a long period, please turn off at least 15 minutes and then on again.

Safety and Maintenance: During use, do not disassemble this product; do not make the machine subject to severe vibration and impact; please avoid liquid contact, if not accidentally come into contact, immediately disconnect the power supply and contact the supplier. Do not place the device in direct sunlight, moisture, excessive dust or excessive heat.